

Transmission Fluid Cooler Tubes

Special Tool(s)

 <p>ST2935A</p>	Disconnect Tool, Transmission Cooler Line 307-569
--	--

Material

Item	Specification
MERCON® V Automatic Transmission Fluid XT-5-QM (or XT-5-QMC) (US); CXT-5-LM12 (Canada)	MERCON® V

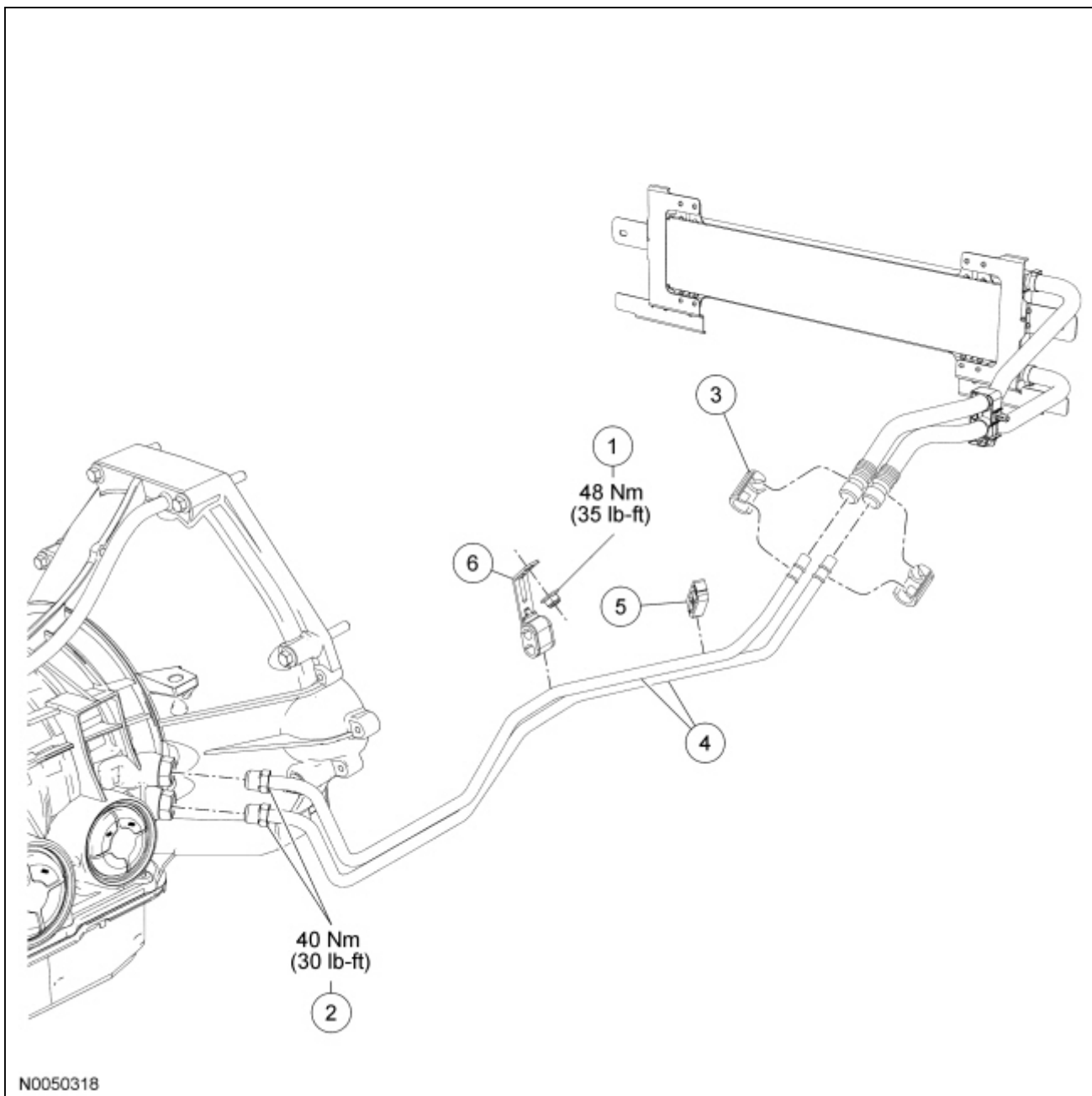

N0050318

Item	Part Number	Description
1	—	Transmission fluid cooler tube bracket nut
2	—	Transmission fluid cooler tube nuts (part of 7R081)
3	7Z465	Transmission fluid cooler tube quick connect secondary latch
4	7R081	Transmission fluid cooler tube assembly
5	—	Transmission fluid cooler tube retainer (part of 7R081)
6	—	Transmission fluid cooler tube bracket (part of 7R081)

Removal

All vehicles

1. With the vehicle in NEUTRAL, position it on a hoist. For additional information, refer to [Section 100-02](#).

4.6L engines

2. Remove the transmission fluid cooler tube nut and bracket from the engine.

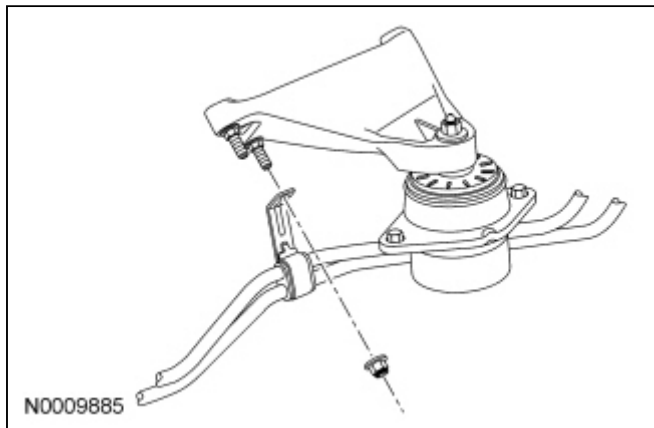

4.0L engines

3. Remove the transmission fluid cooler tube bolt and bracket from the engine.

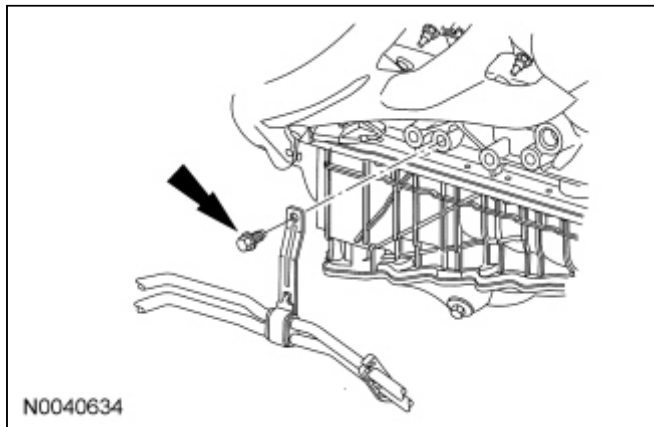

All vehicles

4. **NOTE:** Use a backup wrench to hold the case fitting secure.

Remove the transmission fluid cooler tube nuts from the transmission.

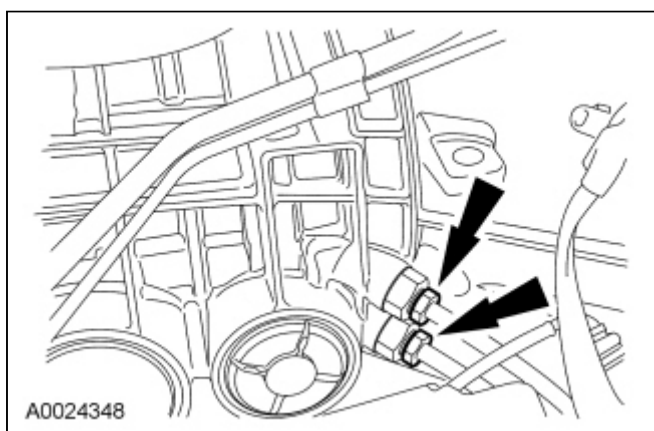

5. Remove both transmission fluid cooler tube quick connect secondary latches.

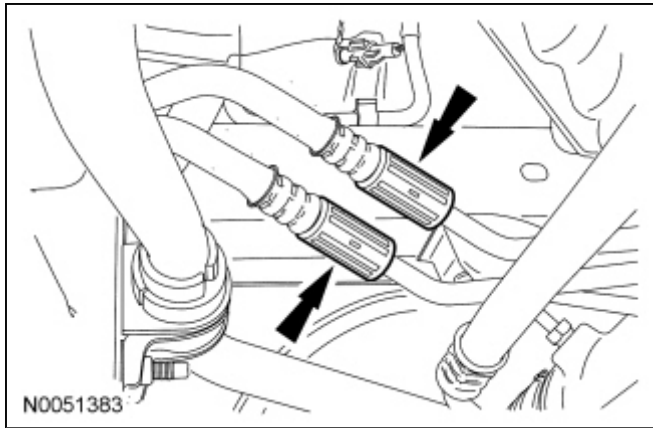

6. Using the Transmission Cooler Line Disconnect Tool, disconnect both transmission cooler tubes from the transmission fluid cooler hoses.

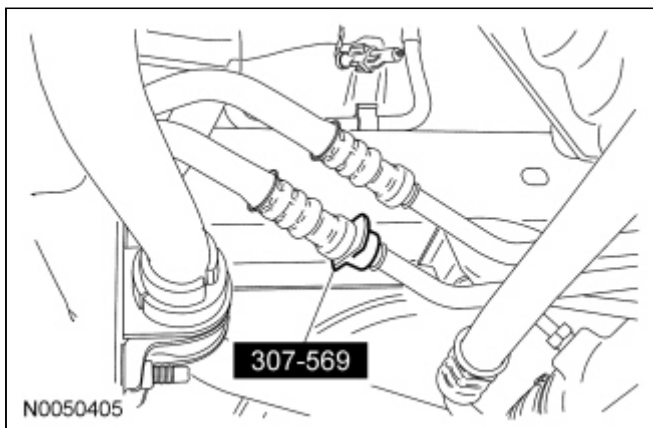

Installation

4.6L engines

1. Loosely install the transmission fluid cooler tube bracket and nut to the engine.

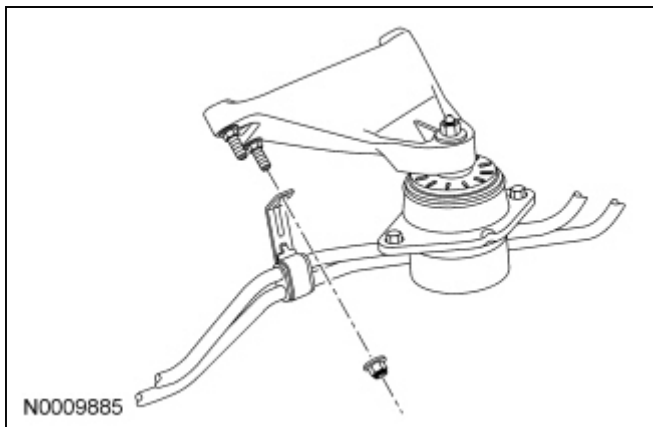

4.0L engines

2. Loosely install the transmission fluid cooler tube bracket and bolt to the engine.

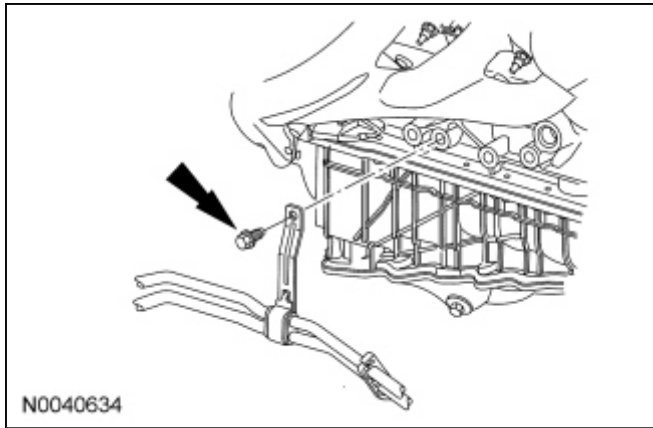

All vehicles

3. Install the transmission fluid cooler hoses on the transmission fluid cooler tubes and install the transmission fluid cooler tube quick connect secondary latches onto the tubes.

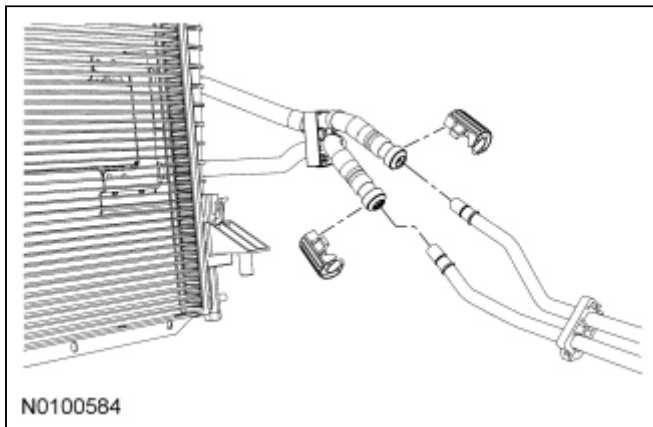

4. **NOTE:** Use a backup wrench to hold the case fitting secure.

Install the transmission fluid cooler tube nuts to the transmission.

- Tighten to 40 Nm (30 lb-ft).

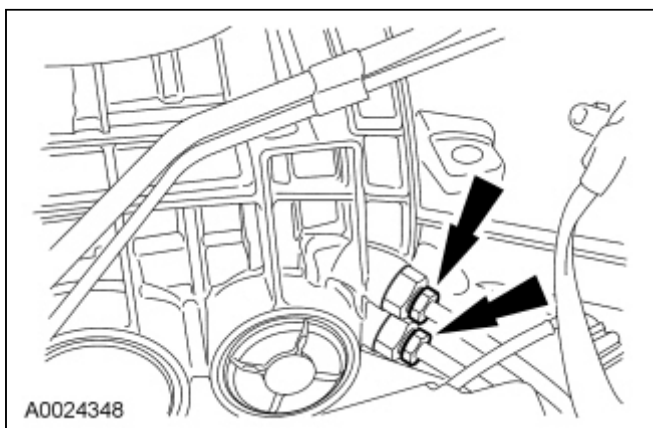

4.6L engines

5. Tighten the transmission fluid cooler tube bracket nut to the engine.
 - Tighten to 48 Nm (35 lb-ft).

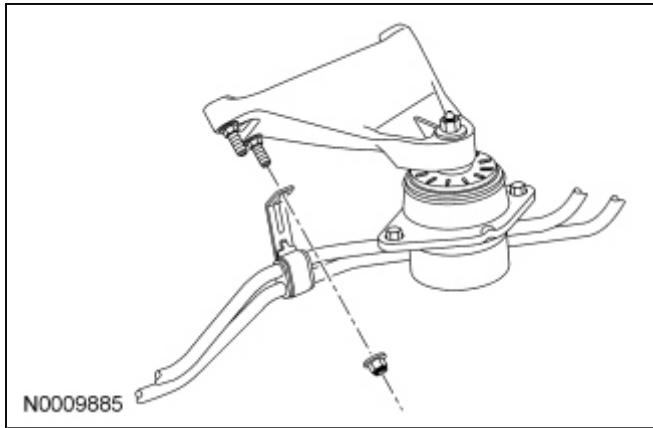

4.0L engines

6. Tighten the transmission fluid cooler tube bracket bolt to the engine.
 - Tighten to 48 Nm (35 lb-ft).

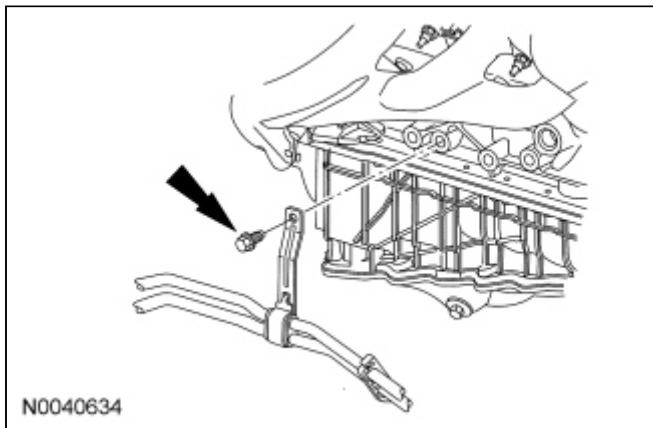

All vehicles

7. Fill the transmission with automatic transmission fluid and verify correct operation.
-